

Threaded Speed Rivet **SHTDCZ**

Head Type	Dome Head
Material	Carbon Steel
Finish	Zinc plate & Yellow passivated

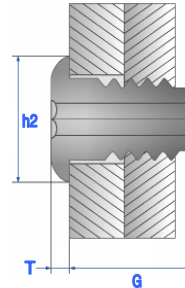
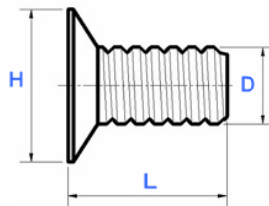

H = Head Diameter
D = Body Diameter
L = Body Length
T = Head Thickness
h2 = Head Diameter
G = Body Length

*Dimensions in millimeters

Part Number	Size ϕ	Rivet Dia (D) max	Hole Size (Front Sheet)	Hole Size (Rear Sheet)	Body Length (L)max. (G)max.	Grip Range	Head Dia (H) max. (h2)	Head Thickness (T) max.
	(Hexagon Key)					(Front) (Rear)		
SHTDCZ-030052	ϕ 3.0 (1/16")	2.8	3.07~ ϕ 15	2.28~ ϕ 89	(L)5.2 (G)4	(Front) 3.07~3.15	(H) 5.4	1.4
SHTDCZ-030061					(L)6.1 (G)5			
SHTDCZ-030071					(L)7.1 (G)6			
SHTDCZ-030081					(L)8.1 (G)7	(Rear) 2.28~2.89	(h2) 5.9~6.2	
SHTDCZ-030091					(L)9.1 (G)8			
SHTDCZ-030101					(L)10.1 (G)9			
SHTDCZ-030131					(L)13.1 (G)11.9			
SHTDCZ-035052	ϕ 3.5 (2mm)	3.1	3.50~ ϕ 58	3.10~ ϕ 17	(L)5.2 (G)4	(Front) 3.50~3.58	(H) 5.6	1.4
SHTDCZ-035061					(L)6.1 (G)5			
SHTDCZ-035071					(L)7.1 (G)6			
SHTDCZ-035081					(L)8.1 (G)7	(Rear) 3.10~3.17	(h2) 6.0~6.2	
SHTDCZ-035091					(L)9.1 (G)8			
SHTDCZ-035101					(L)10.1 (G)9			
SHTDCZ-035141					(L)14.1 (G)11.9			

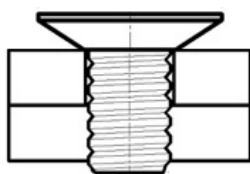

Before

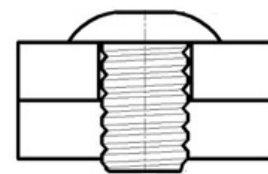
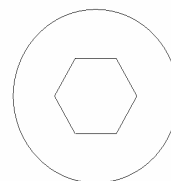
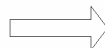
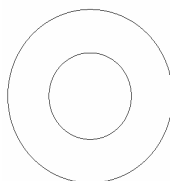

After